

State Water Control Board
 P. O. Box 11143
 2111 North Hamilton St.
 Richmond, Va. 23230

(Certification of Completion/County Permit)

Charles M. Butler - Mason Home Builders
 10023 Old Kent Drive
 Spotsylvania, Va. 22553
 772-2633

25C-3-50

County/City Stafford

County/City Stamp

Permit issued to: - For Sale

• Virginia Plane Coordinates
 N _____
 E _____
 Latitude & Longitude
 N _____
 W _____
 • Topo. Map No. 183A
 • Elevation _____ ft.
 • Formation _____
 • Lithology _____
 • River Basin _____
 • Province _____
 • Type Logs J. L.
 • Cuttings N. A.
 • Water Analysis _____
 • Aquifer Test _____

• Owner _____
 • Well Designation or Number _____
 Address _____
 Phone _____
 • Drilling Contractor John L. Danielson, Jr., Inc.
 Address 4616 Hood Drive
Fredericksburg, Virginia 22408
 Phone (703) 898-6025

SWCB Permit _____
 County Permit _____
 Certification of inspecting official:
 This well does _____ does not _____
 meet code/flow requirements.
 S. _____
 Date _____

For Office Use
 187-89-302 1/21/90 No. 1000
12/8/90 No. 1000
 Tax Map I.D. No. 25-49-3-50
 Subdivision Blake Jarvis
 Section 3
 Block _____
 Lot 50
 Class Well: I _____ IIA _____
 IIB _____ IIA _____ IIB
 IIC _____ IID _____ IIE _____

WELL LOCATION: 1/2 (feet/miles) W. (direction) of Intersection of 612 & 699
 and 2/10 feet/miles N. (direction) of # 649
 (if possible please include map showing location marked)

Date started 5/14/92 • Date completed 5/18/92 Type rig Air Rotary

Approximate Drawdown 220 feet.

WELL DATA: New Reworked _____ Deepened _____
 • Total depth 300 ft.
 • Depth to bedrock 65 ft.
 • Hole size (Also include reamed zones)
 • 10 1/8 inches from 0 to 123 ft.
 • 2 1/8 inches from 123 to 300 ft.
 • _____ inches from _____ to _____ ft.
 • Casing size (I.D.) and material
 • 6 1/4 inches from +1 to 123 ft.
 Material Black Steel
 Wt. per foot 13.6 or wall thickness .188 in.
 • _____ inches from _____ to _____ ft.
 Material _____
 Wt. per foot _____ or wall thickness _____ in.
 • _____ inches from _____ to _____ ft.
 Material _____
 Wt. per foot _____ or wall thickness _____ in.
 • Screen size and mesh for each zone (where applicable)
 • _____ inches from _____ to _____ ft.
 • Mesh size _____ Type _____
 • _____ inches from _____ to _____ ft.
 • Mesh size _____ Type _____
 • _____ inches from _____ to _____ ft.
 • Mesh size _____ Type _____
 • _____ inches from _____ to _____ ft.
 • Mesh size _____ Type _____
 • _____ inches from _____ to _____ ft.
 • Mesh size _____ Type _____
 • Gravel pack
 • From _____ to _____ ft.
 • From _____ to _____ ft.
 • Grout
 • From 0 to 50 ft. Type Pressure Grouting
Baroids Cement
Baroids Cement & EZ Mud Slurry
 • From _____ to _____ ft. Type _____

2. WATER DATA • Water temperature _____ of _____
 • Static water level (unpumped level measured) 40 ft.
 • Stabilized measured pumping water level 260 ft.
 • Stabilized yield 4 gpm after 1 hours
 Natural Flow: Yes _____ No Flow rate _____ gpm
 Comment on quality _____
 3. WATER ZONES: From 180 To 181
 From 280 To 281 From _____ To _____
 From _____ To _____ From _____ To _____
 4. USE DATA:
 Type of use Drinking Livestock Watering _____
 Irrigation _____ Food processing _____ Household
 Manufacturing _____ Fire safety _____ Cleaning _____
 Recreation _____ Aesthetic _____ Cooling or heating _____
 Injection _____ Other _____
 • Type of facility Domestic Public water supply _____
 Public institution _____ Farm _____ Industry _____
 Commercial _____ Other _____
 5. PUMP DATA: Type _____ Rated H P _____
 • Intake depth _____ • Capacity _____ at _____ head
 6. WELLHEAD: Type well seal _____
 Pressure tank _____ gal. Loc. _____
 Sample tap _____ Measurement port _____
 Well vent _____ Pressure relief valve _____
 Gate valve _____ Check valve (when required) _____
 Electrical disconnect switch on power supply _____
 7. DISINFECTION: Well disinfected _____ yes _____ no _____
 Date _____ Disinfectant used _____
 Amount _____ Hours used _____
 ABANDONMENT (where applicable) • yes _____ no _____
 Casing pulled yes _____ no _____ not applicable _____
 Plugging grout From _____ to _____ material _____
 Pump installed through _____

Installed Watertight Top
Suggest setting pump @ approx 280 Ft.
OVER

9. State law requires submitting to the Virginia State Water Control Board information about groundwater and wells for every well in the State intended for water, or any other non-exempt well. This information must be submitted whether the well is completed, on standby, or abandoned. Information required includes: an accurately and completely prepared water well completion report, full data from any aquifer pumping tests, drill cuttings taken at ten foot intervals (unless exemption is secured), the results of any chemical analyses, and copies of any geophysical logs. Quarterly pumpage and use reports are required from owners of public supply and industrial wells. County or State permits to drill may be required in some parts of the state. Some counties require submission of a water well completion report. The Virginia State Health Department requires a water well completion report for public supply wells.

10. DRILLERS LOG (use additional Sheets if necessary)

DEPTH (feet)		TYPE OF ROCK OR SOIL (color, material, fossils, hardness, etc.)	REMARKS (water, caving, cavities, broken, core, shot, etc.)
From	To		
0	10	Red Clay	
10	65	Miocene formation/Brown	
65	123	Broken Rock	
123	240	Dark Grey Rock	
240	300	Light Grey Rock	

Approximate
Water zones
180 to 181
and
280 to 281

11.

Drilling Time (Min.)

12. DIAGRAM OF WELL CONSTRUCTION (with dimensions)

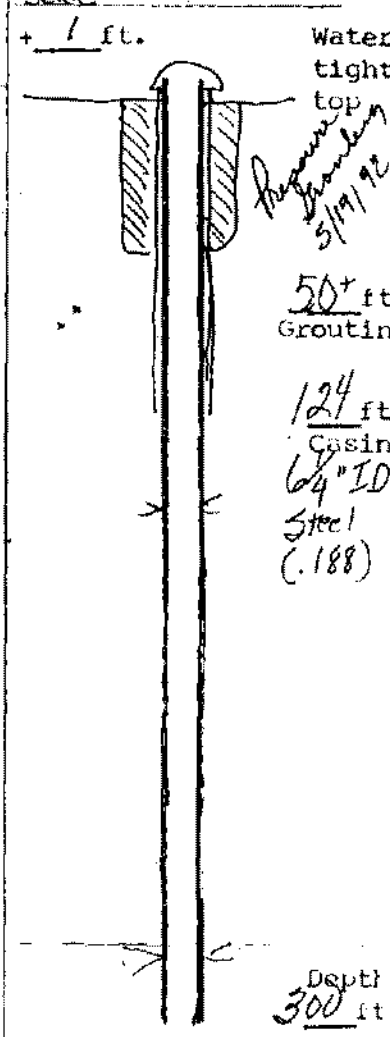

State Water Control Board Regional Offices

Valley Reg. Off.
116 North Main Street
P. O. Box 268
Bridgewater, Va 22812
703-828-2595

Piedmont Reg. Off.
4010 West Broad Street
P. O. Box 6618
Richmond, Va. 23230
804-257-1006

Southwest Reg. Off.
408 East Main Street
P. O. Box 476
Abingdon, Va 24210
703-628-5183

Tidewater Reg. Off.
287 Pembroke Office Park
Suite 310 Pembroke No. 2
Va. Beach, Va. 23462
804-499-8742

West Central Reg. Off.
Executive Park
5312 Peters Creek Road
Roanoke, Va. 24019
708-982-7432

Northern Virginia Reg. Off.
5515 Cherokee Avenue
Suite 404
Alexandria, Va. 22312
703-750-9111

13. Well lot dedicated? _____; Size _____ ft. X _____ ft., Well house? _____
Distance to nearest pollutant source _____ ft., Type _____
Distance to nearest property line _____ ft., Building _____ ft.

14. WATER SERVICE PIPE: Checked under _____ p. s. i. for _____ minutes. Pipe size _____ inches, Material _____
Installer _____
Date _____

15. I certify that the information contained herein is true and correct and that this well and/or system has been installed and constructed in accordance with the requirements for well construction as specified in compliance with appropriate county or independent city ordinances and the laws and rules of the Commonwealth of Virginia.

Signature Clara T. Danielson (Seal), Date 5/19/92
(Well driller or authorized person)

License No. _____

Schematic drawing of sewage disposal system and topographic features.

Show the lot lines of the building lot and building site, sketch of property showing any topographic features which may impact on the design of the system, all existing and/or proposed structures including sewage disposal systems and wells within 100 feet of sewage disposal system and reserve area. The schematic drawing of the sewage disposal system shall show sewer lines, pretreatment unit, pump station, conveyance system, and subsurface soil absorption system, reserve area, etc. When a nonpublic drinking water supply is to be located on the same lot show all sources of pollution within 100 feet.

The information required above has been drawn on the attached copy of the sketch submitted with the application. Attach additional sheets as necessary to illustrate the design.

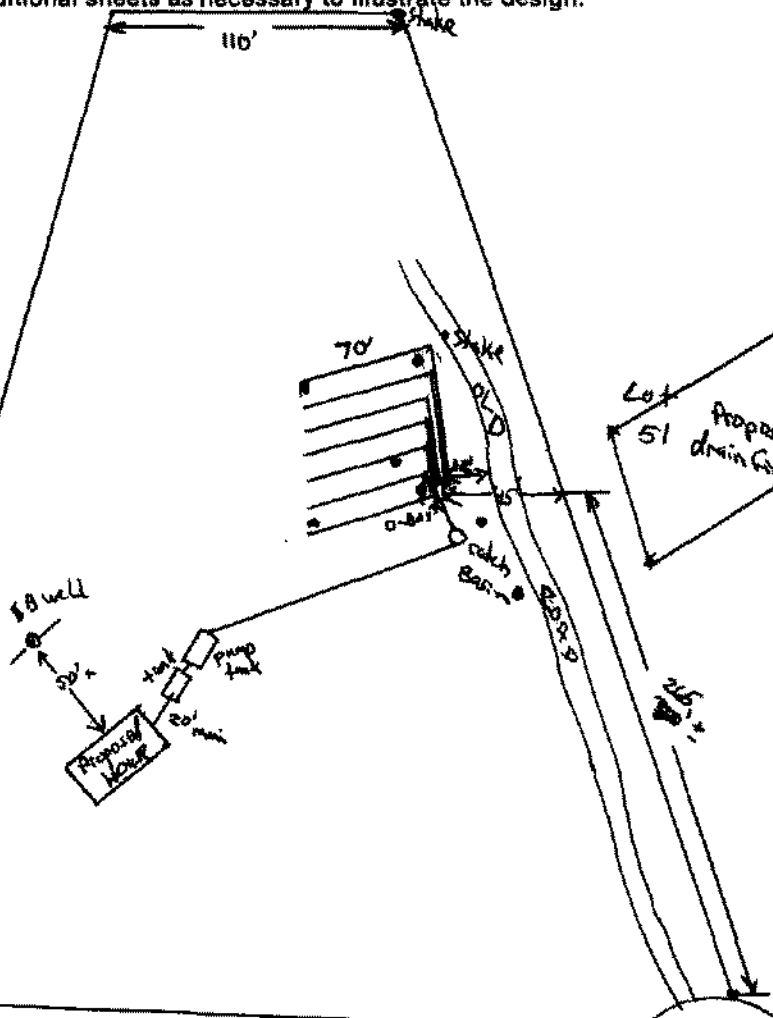

- * Drawing not to scale.
- * Permit void if house location interferes with proposed drainfield location.
- * Drainfield to be 100'+ from all Class III wells and 50'+ from all Class II wells.
- * Remove all trees within 10' of drainfield.
- * Install (7) 70' lines in 36" wide ditches following land contours.
- * Install septic tank and distribution box with 18 to 24" maximum cover.
- * Install ditches 45" deep.
- * Follow OSHA Codes.
- * Header lines to extend 24" into ditches.
- * Place untreated building paper over gravel in ditches.
- * Designed for basement plumbing? (Yes) No
- * Pump septic tank every 3 to 5 years.
- * Keep driveway off drainfield system.
- * Divert roof drains away from drainfield.
- * Install Class III well 50' from all sources of contamination.
- * Well shall not be located in a low area.
- *** PUMP SYSTEM REQUIREMENTS ***
- * Install check valve at pump and elbow in basin.
- * Pump to deliver 196 gallons per cycle (13" drawdown for a 252 gallon tank).
- * Install alarm panel with audio and visual signals in dwelling.
- * Contractor to supply pump specifications.
- * Building inspector to check all wiring.
- * Sanitarian to observe pump operation.
- * Well curbing to be used for catch basin.

The sewage disposal system is to be constructed as specified by the permit or attached plans and specifications .

This sewage disposal system construction permit is null and void if (a) conditions are changed from those shown on the application (b) conditions are changed from those shown on the construction permit.

No part of any installation shall be covered or used until inspected, corrections made if necessary, and approved, by the local health department or unless expressly authorized by the local health dept. Any part of any installation which has been covered prior to approval shall be uncovered, if necessary, upon the direction of the Department.

Date: Jan 29, 1940 Issued by: Richard Smith Sanitarian

Date: 2-8-50 Reviewed by: O. M. Deal Supervisory Sanitarian

This Construction Permit Valid until July 1941

If FHA or VA financing

Reviewed by Date _____ Date _____